

5 Detach the TV

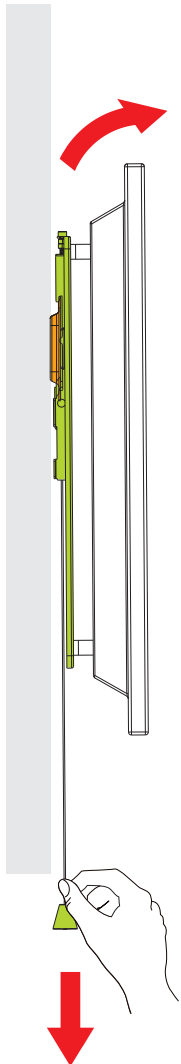

To detach the TV assembly from the wall plate, using an assistant, pull the cords at the bottom of the brackets, and tilt the TV up to snap out of the brackets, then lift the TV to detach it from the wall plate.



QualGear®

INSTALLATION MANUAL

QG-TM-F-014

ULTRA LOW PROFILE FIXED TV WALL MOUNT

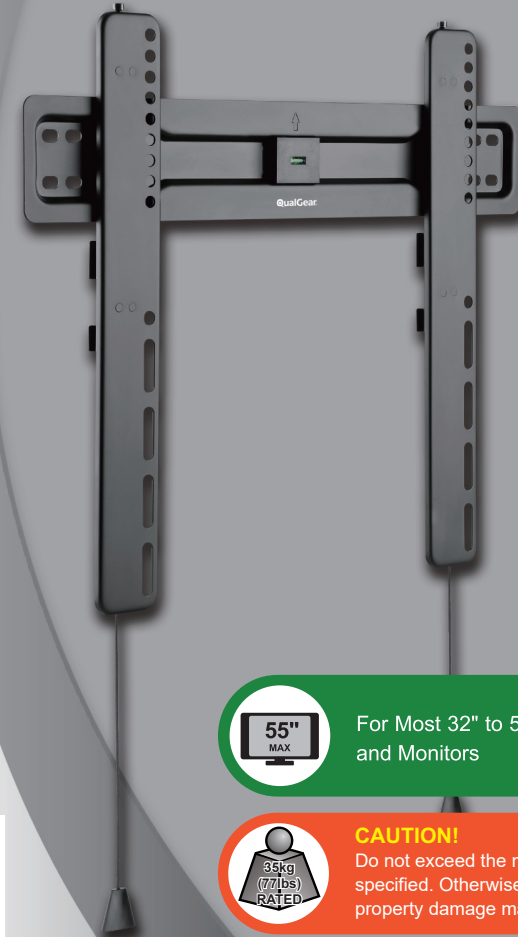

For Most 32" to 55" Flat Screen TVs and Monitors



CAUTION!

Do not exceed the maximum rated weight specified. Otherwise, serious injury or property damage may occur.



VESA

100x100 | 100x150 | 100x200 | 150x100 | 150x150
200x100 | 200x200 | 300x200 | 300x300 | 400x200
400x300 | 400x400



www.qualgear.com

■ 1-Year Limited Warranty

■ Version: July 2023

NOTE Please read the entire installation manual before you start installation and assembly.

WARNING

- Do not begin to install your QualGear product until you have read and understood all the instructions and warnings contained in this installation manual. If you have any questions regarding the instructions, for US customers please contact QualGear customer support via email at support@qualgear.com. For all international customers, please contact your local distributor.
- This product should only be installed by someone of good mechanical aptitude, has experience with basic building construction, and fully understands these instructions.
- This product was designed to be installed and utilized only as specified in this manual. Improper installation of this product may cause damage or serious injury. QualGear is not liable for the improper use or installation of its products.
- Make sure that the supporting surface will safely support the combined load of the equipment and all attached hardware and components.
- Always use an assistant or mechanical lifting equipment to safely lift and position the equipment.
- Tighten screws firmly, but do not over tighten. Over tightening can damage the items, greatly reducing their holding power.
- ALL QUALGEAR products are intended for indoor use only and any outdoor use voids the limited warranty.
- ALL QUALGEAR products are designed and tested for residential use only and any commercial use voids the limited warranty. For warranty information, please visit <http://www.qualgear.com/warranty.php>.
- If mounting to wooden studs, make sure that mounting screws are anchored into the center of the studs. Use of an edge-to-edge stud finder is highly recommended.
- Never exceed the maximum rated weight specified in this manual.
- All bolts and screws must be used at the designated points in the installation instructions to prevent property damage and/or personal injury.
- DO NOT install near air conditioner vents or where there is excessive dust or smoke.
- When drilling holes in the wall, it is very important to take care of electrical cables, water, or gas pipes in the wall.
- This product was designed to be installed on the following wall construction only:

WALL CONSTRUCTION

Wooden Stud
Wooden Beam
Solid Concrete
Other

HARDWARE REQUIRED

Included
Included
Included
Contact Qualified Professional

Parts Checklist

IMPORTANT: Before starting installation, please check that all parts shown in this checklist are included. If any parts are missing or damaged, contact your local distributor or support@qualgear.com for replacement parts and do not start assembly and installation until you receive all the parts.



Adapter Bracket (x2)
A



Wall Plate (x1)
B



Allen Wrench (x1)
4mm
C

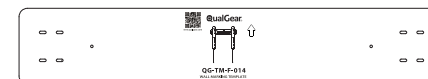

Marking Template (x1)
D

Hardware Package



M6x14mm (x4)
M-A



M8x16mm (x4)
M-B



M6x30mm (x4)
M-C

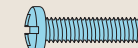

M8x35mm (x4)
M-D



D8 (x4)
M-E



Ø15xØ8x5 (x4)
M-F



Ø15xØ8x15 (x4)
M-G



ST6.3x55mm
Lag Bolt (x4)
W-A



10x45mm
Concrete Anchor (x4)
W-B



D6 Washer (x4)
W-C

1a Mounting to a Wooden Stud Wall

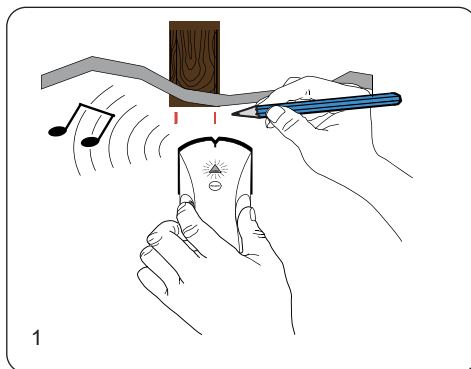

Using an edge-to-edge stud finder, find the edges of the stud.

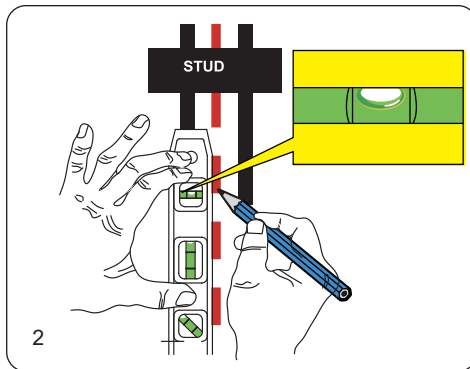

Using a level, mark the centerline of the stud.

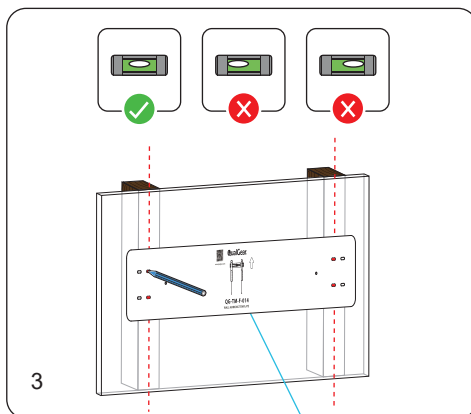

D Marking Template

Using the marking template (D) provided, mark four holes for drilling on the centerline of the stud.

TIP First, determine stud spacing and choose two holes on each side accordingly. Then, mark four holes on the wall using the template provided.

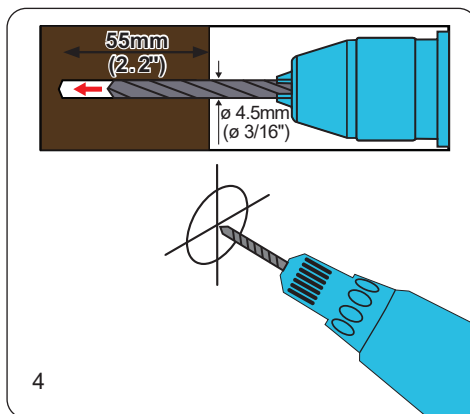

Using a power drill and 3/16" drill bit, drill pilot holes of 3/16" (4.5 mm) diameter and at least 2.2" (55 mm) depth.

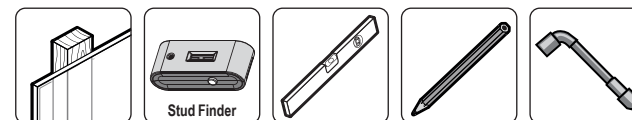

NOTE For concrete wall mounting, follow Step 1b.

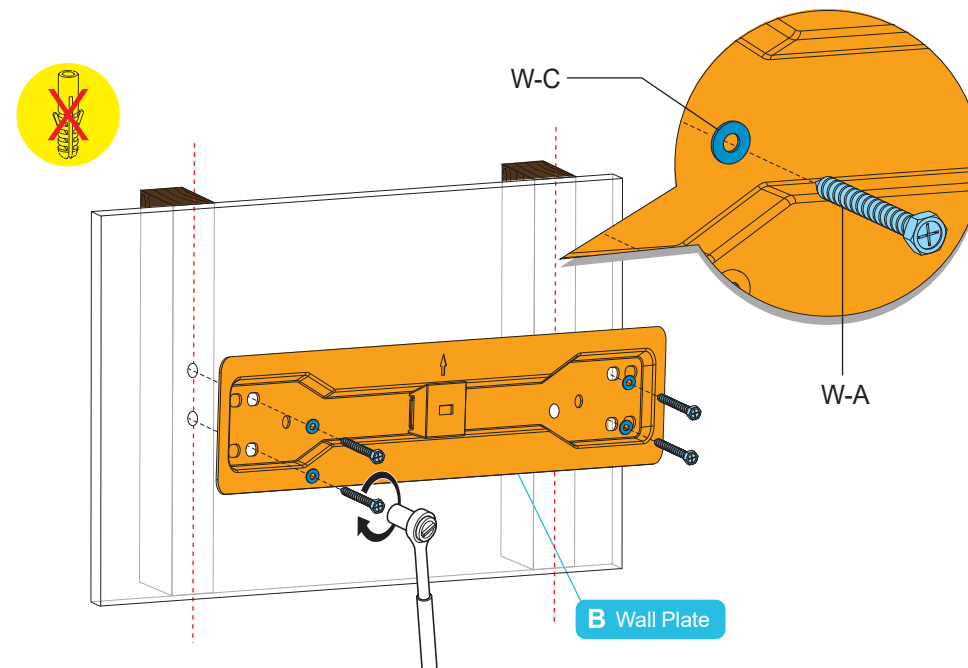

5 Mount the wall plate (B) and tighten it with the provided lag bolts (W-A) and D6 washers (W-C) using a socket wrench.

NOTE Do NOT use power drill and do NOT over tighten the lag bolts.

! WARNING

- Make sure that mounting screws are anchored into the center of the studs. The use of a stud finder is highly recommended.
- Installers are responsible to provide hardware for other types of mounting situations.
- Installers must verify that the supporting surface will safely support the combined weight of the equipment and all attached hardware and components.

SKIP TO STEP 2 →

1b Mounting to a Concrete or Brick Wall

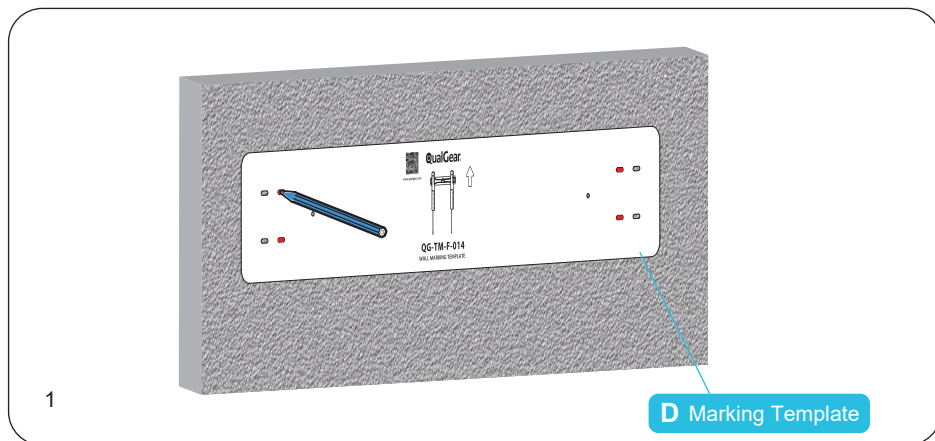
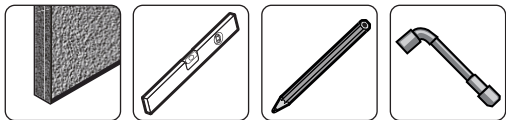

Hold the marking template (D) provided against the wall where you want to install your TV, mark four holes for drilling.

TIP Choose two holes on each side. Then, mark four holes on the wall using the template provided.

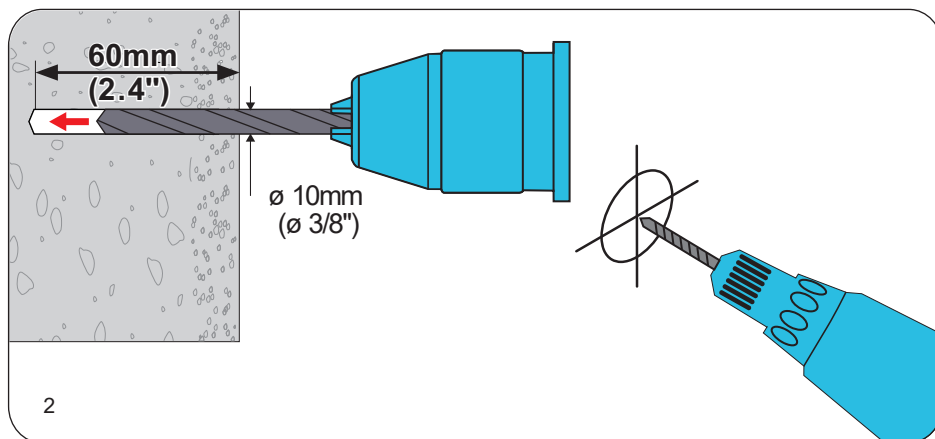

Using a power drill and a 3/8" masonry drill bit, drill mounting holes of 3/8" (10 mm) diameter and 2.4" (60 mm) depth at the marked locations in the previous step.

NOTE Do NOT use power drill and do NOT over tighten the lag bolts.

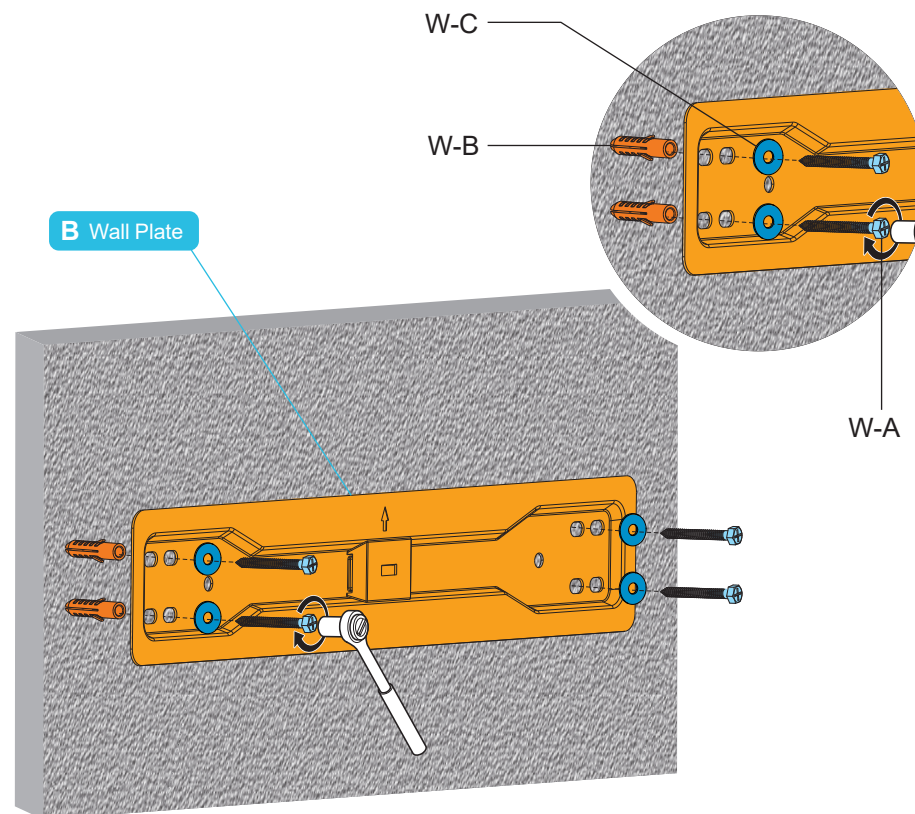

- Place concrete anchors (W-B) in each hole. Tap each anchor flush with the wall using a hammer. Using a socket wrench, mount the wall plate (B) and fasten them with the provided lag bolts (W-A) and D6 washers (W-C).

WARNING

- Installers must verify that the supporting surface will safely support the combined weight of the equipment and all attached hardware and components.

2 Attach TV Brackets

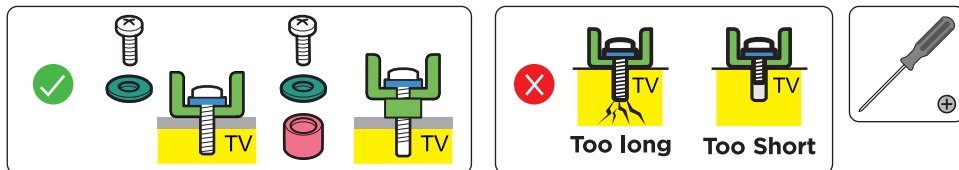

IMPORTANT!
Tighten all screws but do NOT over tighten

TIP Use a toothpick to measure the depth of the mounting hole and choose the appropriate mounting screws.

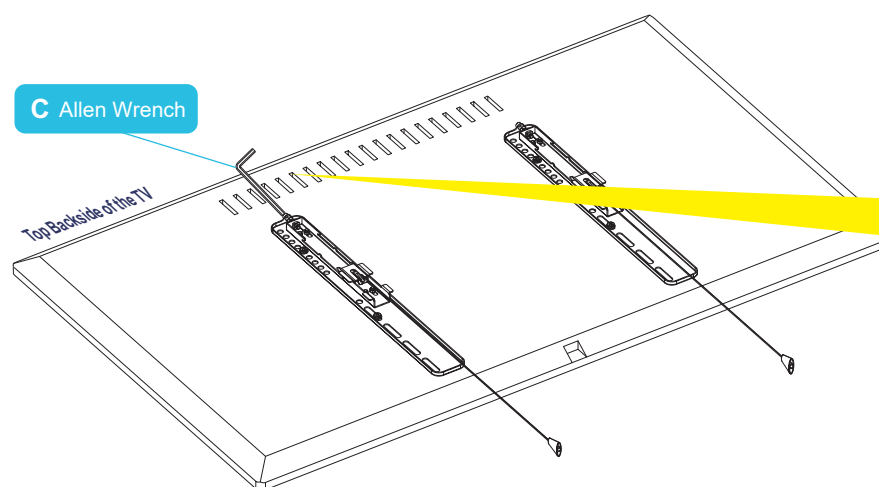
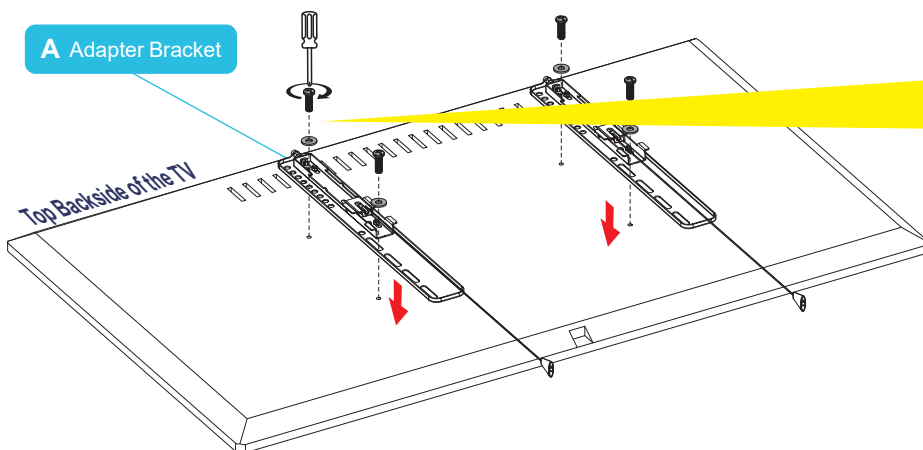

Choose the appropriate screws and washers according to the type of your TV, and attach adapter brackets (A) to the back of the TV using a Phillips screwdriver.

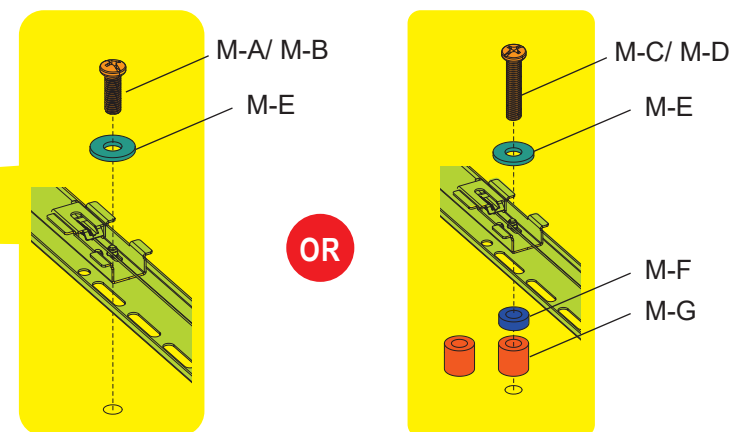

TIP Use one or more spacers for TVs with curved or recessed back panels as necessary.

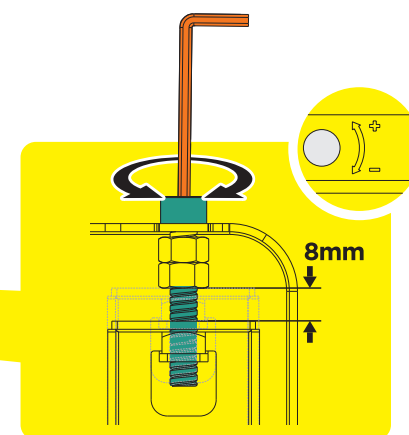

Once the brackets are attached to the TV securely, ensure that the level adjustment screws are set on either side, as illustrated in the picture above.

3 Hang the TV



Once the brackets are attached to the TV, using an assistant, place the brackets on the wall plate securely. While holding the TV assembly securely, pull the cords at the bottom of the brackets and push the TV assembly to snap on the wall plate firmly.

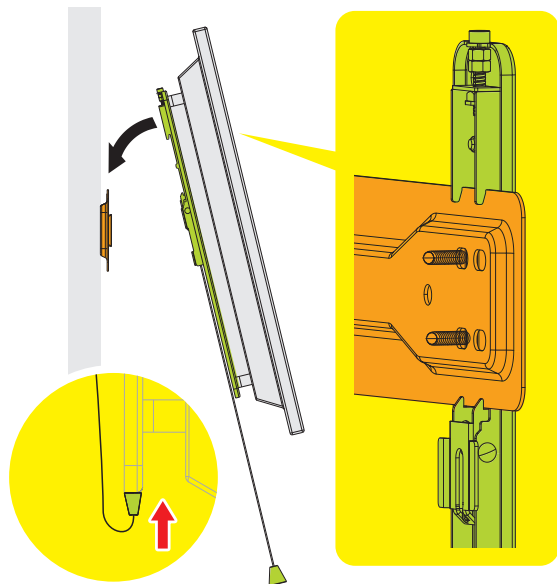

4 Level the TV

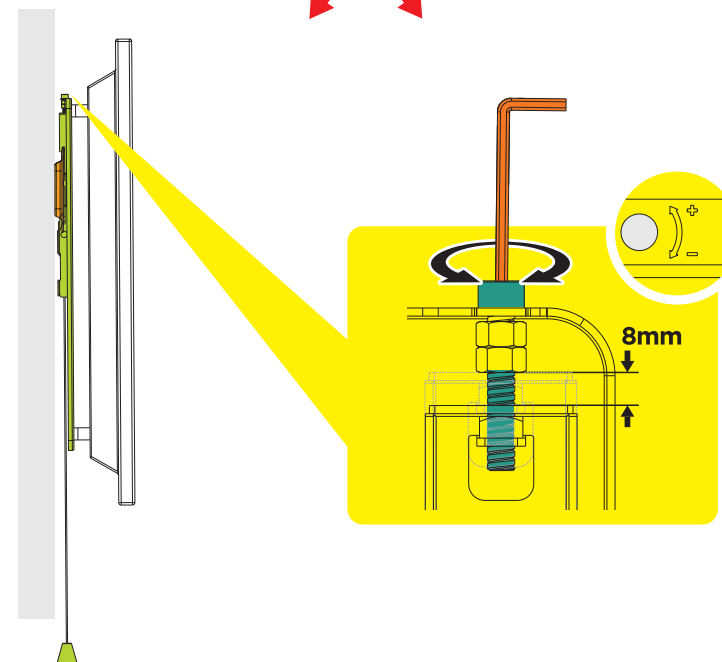
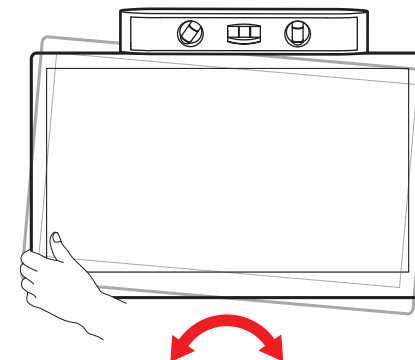
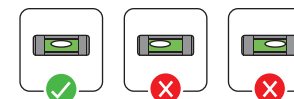

After the TV is placed on the wall plate securely, check the level of the TV to ensure that it is perfectly level. Use the level adjustment screws on the adapter brackets to adjust the level of the TV, as illustrated in the picture above.